



# Time to check your overspeed?



## **TG611**

### **API 611 Compliant Overspeed Testing**

*Easily overspeed test your steam turbine using the new  
Woodward TG611 governor with integral overspeed  
test device.*



Turbomachinery Controls  
Improve Reliability • Enhance Performance

**API STANDARD 611**, Fifth Edition, March 2008, Paragraph 7.4.2.2.11 states:

“Unless otherwise specified, the oil relay governor shall include a manual method to safely increase the speed of the turbine over the maximum continuous speed of the governor to allow for a safe and controlled test of the independent emergency overspeed system. This system shall be arranged that releasing of the device shall allow the turbine to return to maximum continuous speed with no further operator action. This device shall not allow the turbine to exceed the trip setting by 2%.”

**Woodward’s** new TG611 is exactly like your present TG governor, but with built-in overspeed test capabilities that meet the API 611 requirements. The TG611 is:

- field adjustable for overspeed test speed
- allows testing from any speed setting
- easy to use:
  - remove the overspeed test device cap
  - insert the cap’s dowel pin into the cam
  - rotate it like a lever to increase the speed to its overspeed trip

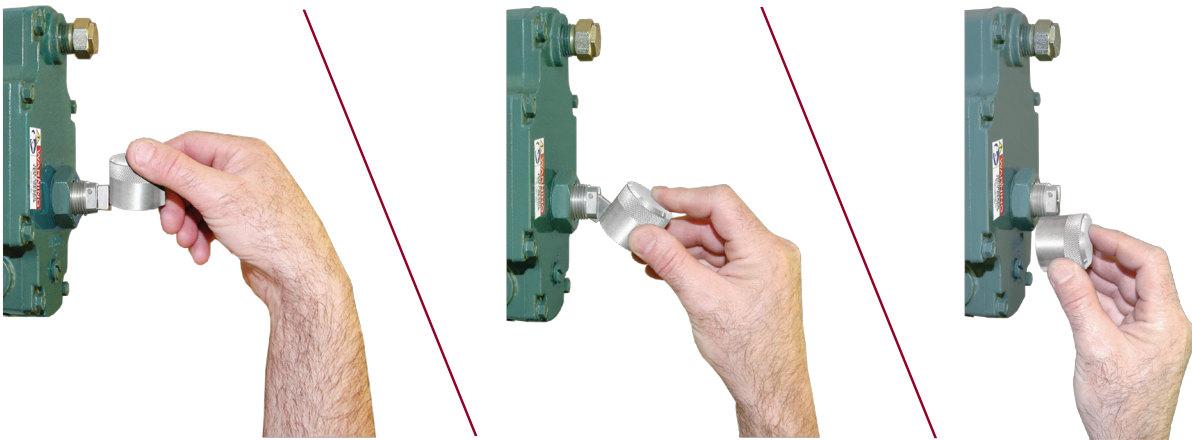

- maintains governor control during overspeed testing
- releasing the cam at any time during the test causes the TG611 to immediately return to its normal speed setting.

***Ask for the TG611 for your next new or replacement TG unit  
and how your existing TG unit can be upgraded into a TG611.***

For more information go to [www.woodward.com](http://www.woodward.com) or email [turboinfo@woodward.com](mailto:turboinfo@woodward.com)

or

Contact your local Woodward Distributor



Turbomachinery Controls  
Improve Reliability • Enhance Performance